

F32B Series - 195mm middle size pipe size 1/2"-1" **F32B series**



Product Features · Use

- Designed for use with highly corrosive solutions.
- Equipped with an inductor, which confirms the pipeline's current capacity by means of detecting the floating migration. The inductor can be connected instruments or computers and is often used as part of the control or alarm system.
- Patented dual-indicator design for easy and clear flow range management.
- Laser engraved degree scales provide better readability and longer life.
- Available in customizable units, temperature, and molecular weight.
- Each batch of flow meters will be calibrated before delivery for our best precision guarantee.

Standard Specs

- Model: F32B PSU, F32B w/ Inductor PSU
- Adaptor Size: 1/2", 3/4", 1"
- Applicable Fluid: Liquid (Highly corrosive)
- Flow direction: From the bottom up
- Engraved degree scales: Laser engraved degree scales
- Fluid Temperature: 50°C (Standard: UPVC adaptor)
60°C (PP adaptor)

- Working Pressure: 6.0 kg/cm²
- Full Scale Accuracy: ±5% F.S.
- Product Material

Body - PSU
 Float - PP
 Guide Rod - None
 Guide Rod Bottom - PP
 Adaptor - Welding Type: UPVC
 Male, Female Thread: UPVC, PP
 Butt-fusion Adaptor: PP

- Union Nuts - UPVC
 - O-ring - EPDM, VITON
 - Adaptor Material
- Welding Type, Male Thread, Female Thread,
 Butt-fusion Adaptor

※ BSPT is standard thread type. NPT is available for custom

Scale Range

Product Code	Scale Range※	Standard gravity
F32B - 18LPM	9.0-18 L/min	1.0
F32B - 32LPM	16-32 L/min	1.0
F32B - 60LPM	30-60 L/min	1.0
F32B - 90LPM	45-90 L/min	1.0

※ Liquid flow meters are calibrated for 20°C water.

Maximum working temperature for different adaptor materials

Adaptor Types	Maximum working temperature materials	
	~ 50°C	~ 60°C
Welding Type	UPVC	-
Male / Female Thread	UPVC	PP
Butt-fusion Adaptor	PP	PP
Panel Elbow Male Thread	UPVC	-

Parts Material

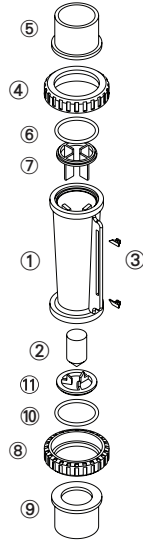

No.	Series	Material (Main material) ^{※ 1}			
		1	2	3	4
1	Body	PSU	PSU	PSU	PSU
2	Float	PP	PP	PP	PP
3	Guide Rod	ABS	ABS	ABS	ABS
4,8	Pointer	UPVC	UPVC	UPVC	UPVC
5,9	Adaptor	UPVC	UPVC	PP ^{※ 2}	PSU ^{※ 3}
6,10	O-ring	EPDM	VITON	VITON	VITON
7,11	Guide Rod Bottom	PP	PP	PP	PP

- ※ 1. Material for different parts is optional for each flowmeter.
- ※ 2. For thread and welding adaptor only.
- ※ 3. For thread adaptor only.

Parts Size

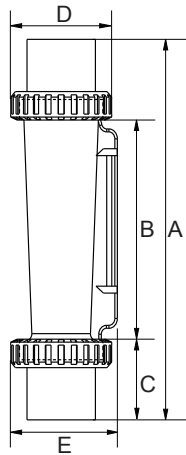

Adaptor Spec	A	B	C	D	E
1"Male Thread	210	111	49.5	60	64
1"Female Thread	210	111	49.5	60	64
1"CNS	197	111	43	60	64
1"ASTM	197	111	43	60	64
1"JIS	195	111	42	60	64
3/4"Male Thread	196	111	42.5	60	64
3/4"Female Thread	211	111	50	60	64
3/4"CNS	199	111	44	60	64
3/4"ASTM	193	111	41	60	64
3/4"JIS	200	111	44.5	60	64
3/4"DIN	199	111	44	60	64
3/4"DIN Thickness Of Pipe Wall	195	111	42	60	64
1/2"JIS MIN	192	111	40.5	60	64
1/2"ASTM	191	111	40	60	64
1/2"JIS	190	111	39.5	60	64
1/2"DIN	189	171	39	60	64
PP OD40.4 ID34	197	111	43	60	64
PP OD33 ID25.2	193	111	41	60	64

Unit: mm

Specification inquiry (F32B)

※ Contact us with below information.

- Fluid - _____
- Specific gravity - Standard-1.0 Other _____
- Pressure - Standard-6.0kg/cm² Other ___ kg/cm²
- Temperature - Normal temperature Other ___ °C
- Scale Range - _____ L/min ~ _____ L/min
- Adaptor Size - 1" JIS
 Other _____
- Adaptor Material
 - Welding Type Male Thread
 - Female Thread Butt-fusion Adaptor
 - Other _____
- Inductor - Yes No
- Other - _____